



INTERNATIONAL
CONFERENCE



2026 FIG & UNECE WPLA International Conference

*Legal Security, Electronic Registers, AI and
Property Valuation*

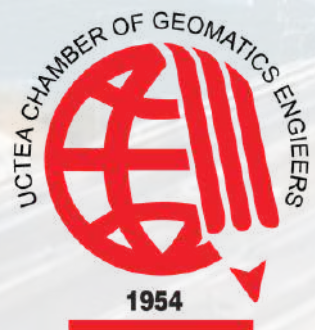

Hosted by The
Chamber of
Geomatics Engineers
of Türkiye (HKMO)

For more
information, visit
our website!





BACKGROUND



The event is organized in cooperation with:

- International Federation of Surveyors (FIG) Commissions 2, 7 & 9
- UNECE Working Party on Land Administration (WPLA)
- General Directorate of Land Registry and Cadastre (TKGM)

The conference will host a selected group of participants to ensure meaningful interaction and high-quality discussions.



CONFERENCE THEMES



Land registry and cadastre systems are rapidly evolving with digitalization, AI, and data ethics, and this Conference will explore current challenges, future smart systems, legal security, property valuation, and professional ethics while promoting practical recommendations for development and capacity building.

Key Themes:

- Legal Security & State Role State liability, compensation, and risk sharing
- Electronic & Digital Land Registers Legal nature and binding effect of electronic registers
- Real Property Valuation & Cadastre Integration Mass appraisal, automated valuation, AI-supported methods
- Artificial Intelligence & Smart Land Administration AI-enabled cadastral updating, change detection, and valuation
- Professional Education & Ethics Continuous professional development, certification, and in-service training



TECHNICAL TOURS



Istanbul Cadastral Directorate

- Overview of Türkiye's cadastral system
- Review of historical documents and key procedures
- Observe land readjustment, development, and expropriation processes

Istanbul Metropolitan Municipality (GIS Directorate)

- Explore the city's integrated urban information systems
- Learn how multi-source datasets support planning and decision-making
- See GIS used for analysis, operational workflows, and cross-department coordination
- Gain hands-on insight into geospatial intelligence in metropolitan management

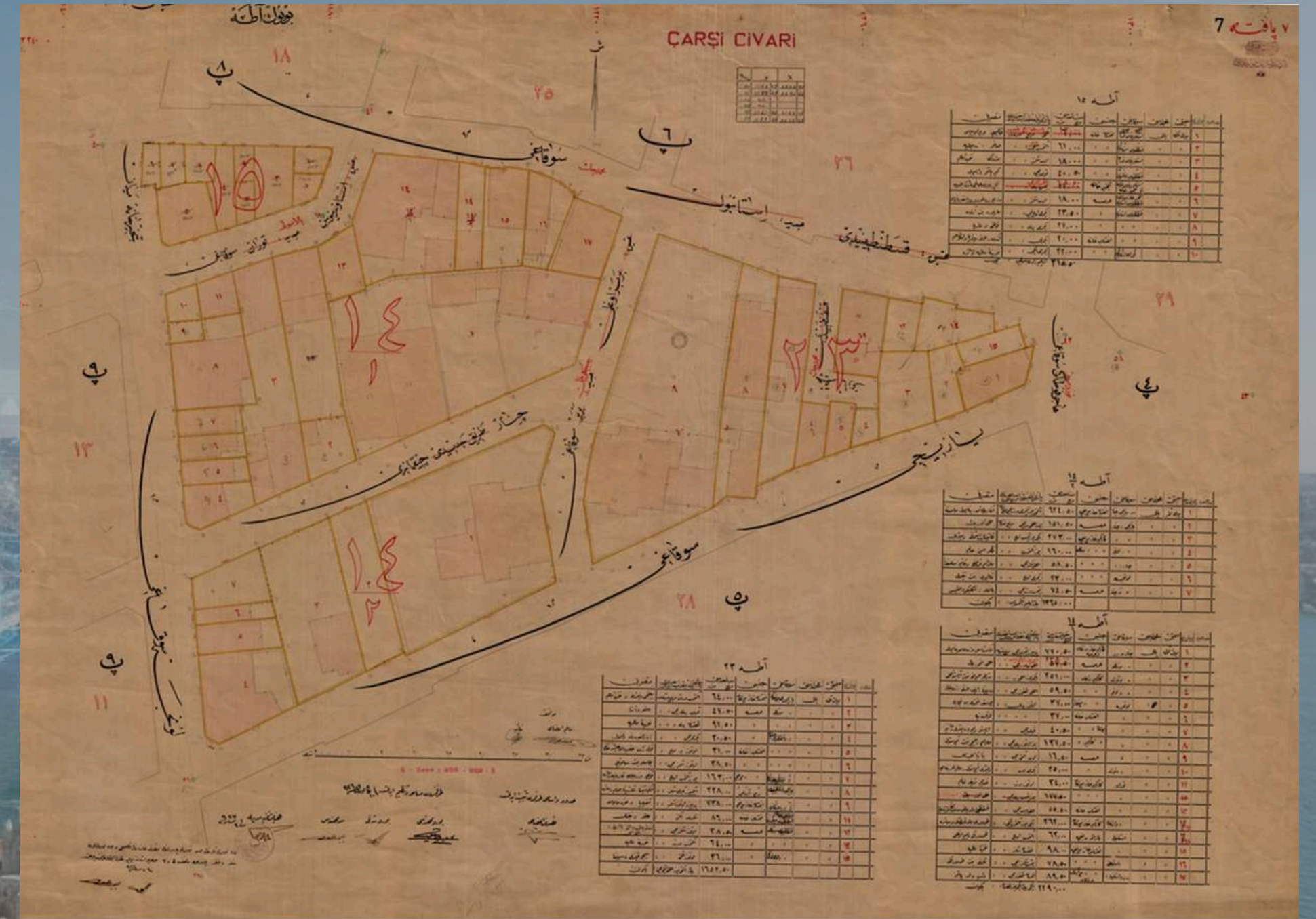

TECHNICAL TOURS



Land Registry Directorates in Istanbul

- Observe how land registry records are systematically created and managed
- Handles 20+ million transactions and including 4 million sales annually
- Gain practical insight into large-scale citizen services

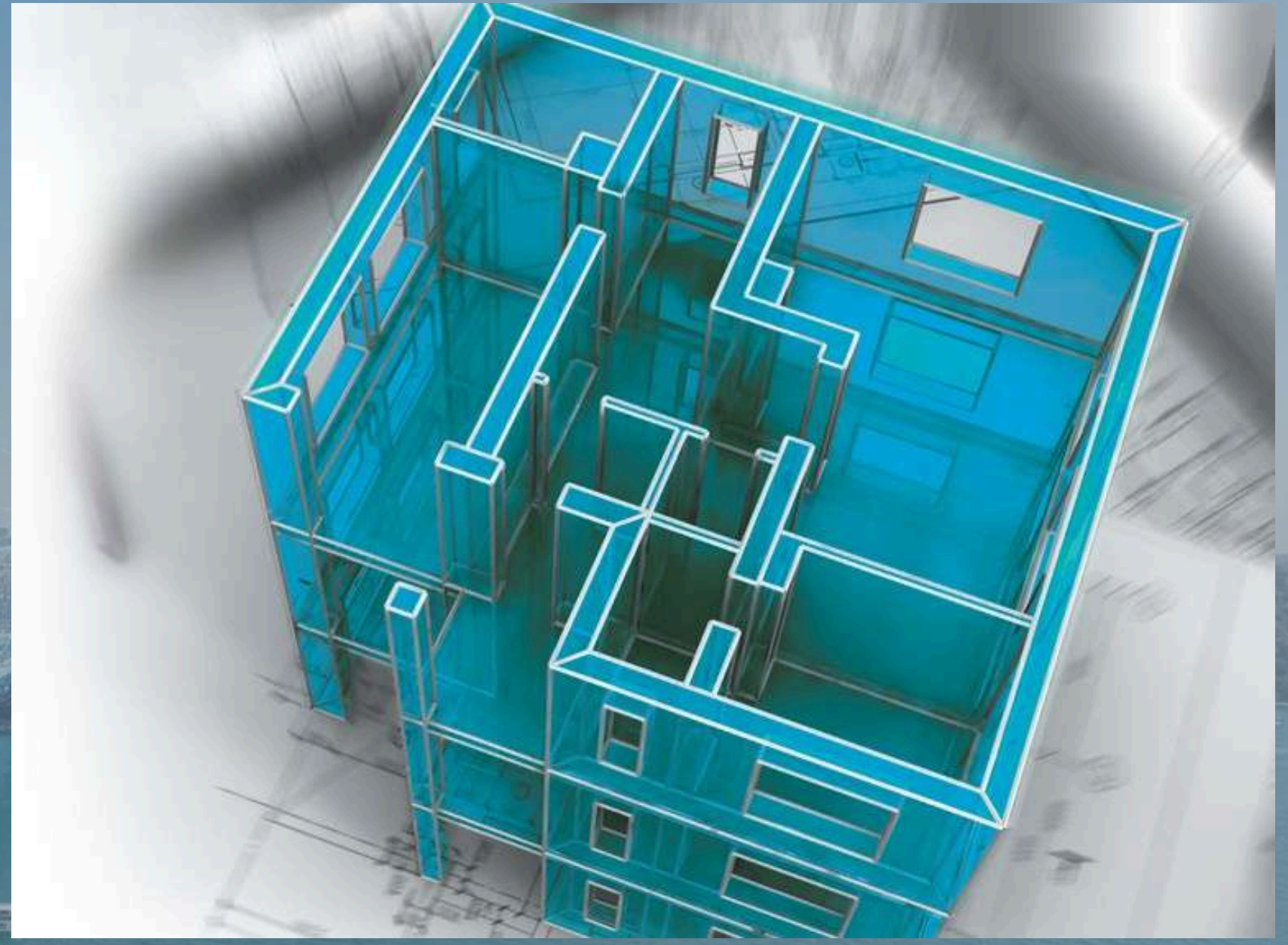



KEYNOTE SPEAKERS

Digitalisation of Land Registers

Jacques Vos (Netherlands)

Board Member, European Land Registry Association



Jacques Vos is a Land Registrar at Kadaster and a Board Member of the European Land Registry Association. His work focuses on the digital transformation of land registration, including interoperability, data standardization, electronic conveyancing processes, and the legal and institutional implications of technology in land registries. He contributes to international cooperation efforts aimed at strengthening legal certainty and public trust through modern, secure, and transparent electronic registration systems.

Geospatial Artificial Intelligence Applications

Prof. Dr. Sultan Kocaman Gökçeoğlu (Türkiye)

Founder, geoPlato Engineering

Holds a PhD in Photogrammetry and Remote Sensing from ETH Zürich and works at the intersection of Earth observation, hazard intelligence, and land-administration systems. As founder and CEO of geoPlato Engineering & Consultancy and Nexa Geo GmbH, she develops explainable-AI frameworks for natural hazard mapping, focusing on how such spatial layers can strengthen modern cadastre, valuation, and risk-governance structures.





KEYNOTE SPEAKERS



Tenure Security Towards Resilience and Sustainability

Pilar Verdejo García (Spain)

Chair, UNECE WPLA (Working Party on Land Administration of the United Nations Economic Commission for Europe); Registrar of the Property

Graduated in Law and Business by the University of Comillas (ICADE) in Madrid. Property and Business Registrar of Spain since 2018. Contact point for Spain at the European Land Registrars Association (ELRA). Director of the Coordination Office of the Iberoamerican Land Registrars Corporation (IBEROREG). Chair of the Working Party on Land Administration of the United Nations Economic Commission for Europe.

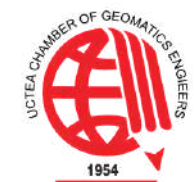

ATTENDANCE



Conference Venue & Accommodation

- Venue: The Marmara Taksim – sessions and accommodation under one roof
- Location: Central at Taksim Square; easy access to public transport and nearby attractions
- Networking: Staying at the venue facilitates movement between sessions and professional exchange
- Accommodation rate: EUR 185 per night (B&B, excluding VAT); reservation details on the conference website

Transportation

- Easily reachable by metro, tram, and bus
- Airport transfers can be arranged (Istanbul Airport & Sabiha Gökçen ~45–60 min)



Conference Highlights

- The conference offers a rich and engaging programme designed to bring together international experts, policymakers, and professionals in land administration.
- Participants will benefit from:
 - 3 Plenary Sessions featuring distinguished keynote speakers on cutting-edge topics
 - 3 Panel Sessions bringing together global experts for interactive discussions
 - Technical Sessions showcasing innovative research and best practices
 - Technical Visits to leading institutions in Istanbul
 - Social Programmes including networking receptions and cultural experiences
 - Exhibition Area presenting the latest technologies and solutions
- In addition, the conference provides excellent networking opportunities, enabling participants to connect, collaborate, and exchange knowledge with peers from around the world.
- We look forward to welcoming you to Istanbul for an inspiring and memorable event.

ISTANBUL



Galata Tower, Istanbul, Türkiye



Ortaköy Mosque & Bosphorus Bridge, Istanbul, Türkiye

Hagia Sophia, Mosaic - Figure of Jesus



Sultanahmet Mosque (Blue Mosque), Istanbul Türkiye



Hagia Sophia, Istanbul, Türkiye

SOCIAL EVENTS OVERVIEW

Accompanying Person Programme

- Two-day guided programme for accompanying guests
- Visits to bazaars, historic districts, and landmarks
- Cultural experience with local insights

Optional Social Tour

- Guided tour of the Historic Peninsula
- Visits to major landmarks and cultural sites
- Bosphorus cruise with panoramic views



Roman Hippodrome, İstanbul



Hagia Sophia, İstanbul Türkiye



Sultanahmet Mosque (Blue Mosque), İstanbul Türkiye



Bosphorus, İstanbul Türkiye



German Fountain, İstanbul



Spice Bazaar, İstanbul



Zeyrek Çinili Hamam, İstanbul

SOCIAL EVENTS OVERVIEW



Welcome Reception (Icebreaker) Venue

- First evening of the conference at The Marmara Taksim poolside
- Relaxed and elegant setting for networking and informal meetings
- Time and details to be announced on the official conference website



Gala Dinner

- Venue: BİZ Istanbul, within the Atatürk Cultural Center (AKM)
- Showcases Istanbul's rich culinary heritage in a modern setting
- Elegant dining with panoramic views of the Historic Peninsula
- Provides networking, conversation, and cultural immersion opportunities

For more information: figcadastre.hkmo.org.tr



Bridging land tenure, value and education for security, sovereignty, and sustainability.

We look forward to continued collaboration with FIG and UNECE WPLA and to welcoming you to Istanbul in October 2026.

SAVE THE DATE

28 - 30 OCTOBER 2026

Limited seats - early registration is recommended.

**HKMO – Local Organizing Committee
FIG Commissions 2, 7 & 9
UNECE WPLA**