

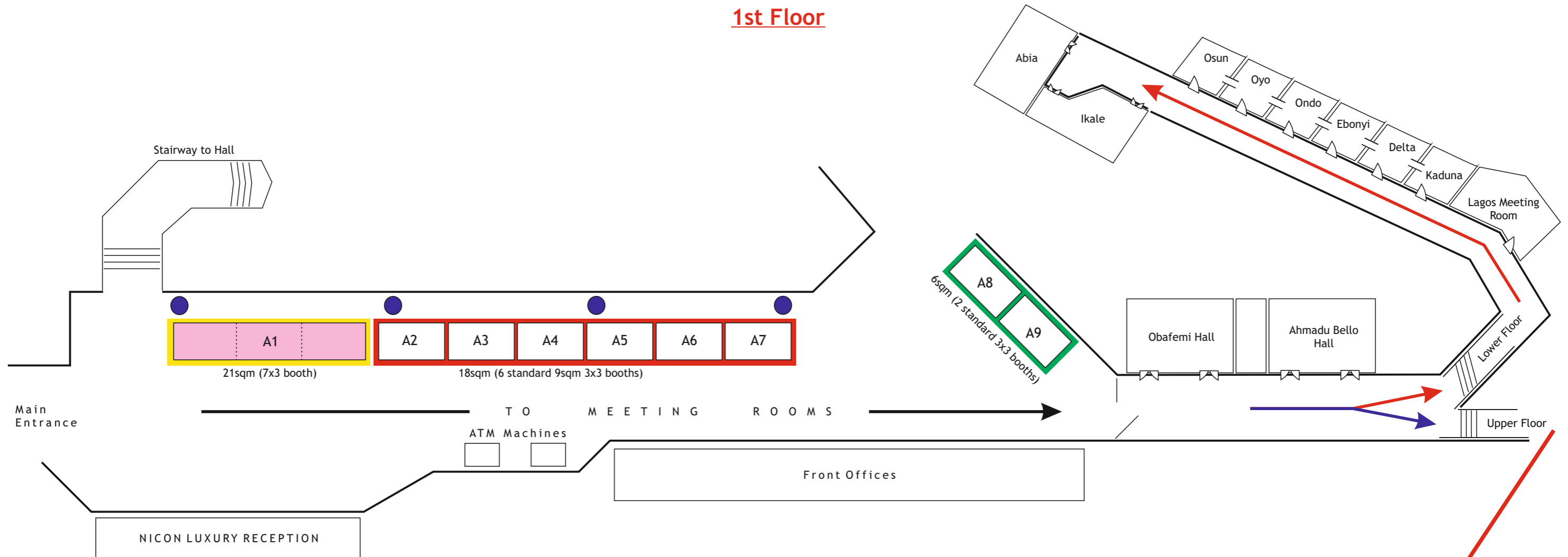

2013 FIG EXHIBITION FLOOR PLAN

NICON LUXURY HOTEL
ABUJA - NIGERIA

1st Floor



Exhibitions Booths
(3x3) - 11

Meeting Rooms:

Obafemi Hall	80 (theatre setting)
Ahmadu Bello Hall	80 (theatre setting)
Lagos Hall	100 (theatre setting)
Kaduna Meeting Room	30 (theatre setting)
Delta Meeting Room	30 (theatre setting)
Ebonyi Meeting Room	30 (theatre setting)
Ondo Meeting Room	30 (theatre setting)
Oyo Meeting Room	30 (theatre setting)
Osun Meeting Room	30 (theatre setting)
Ikale Meeting Room	100 (theatre setting)
Abia Meeting Room	80 (theatre setting)
Ekiti Meeting Room	100 (theatre setting)
Enugu Meeting Room	100 (theatre setting)

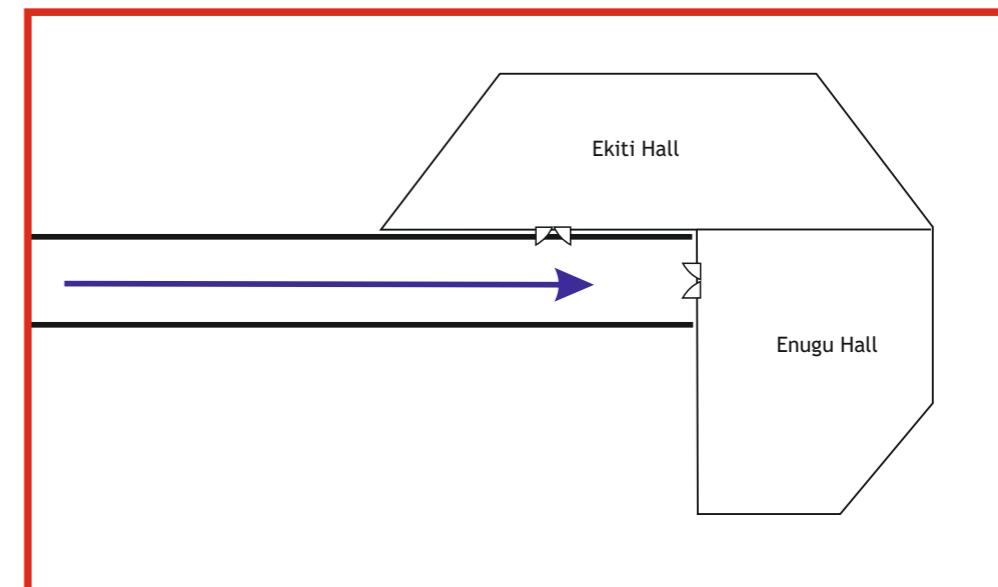



2013 FIG EXHIBITION FLOOR PLAN

NICON LUXURY HOTEL
ABUJA - NIGERIA

Ground Floor

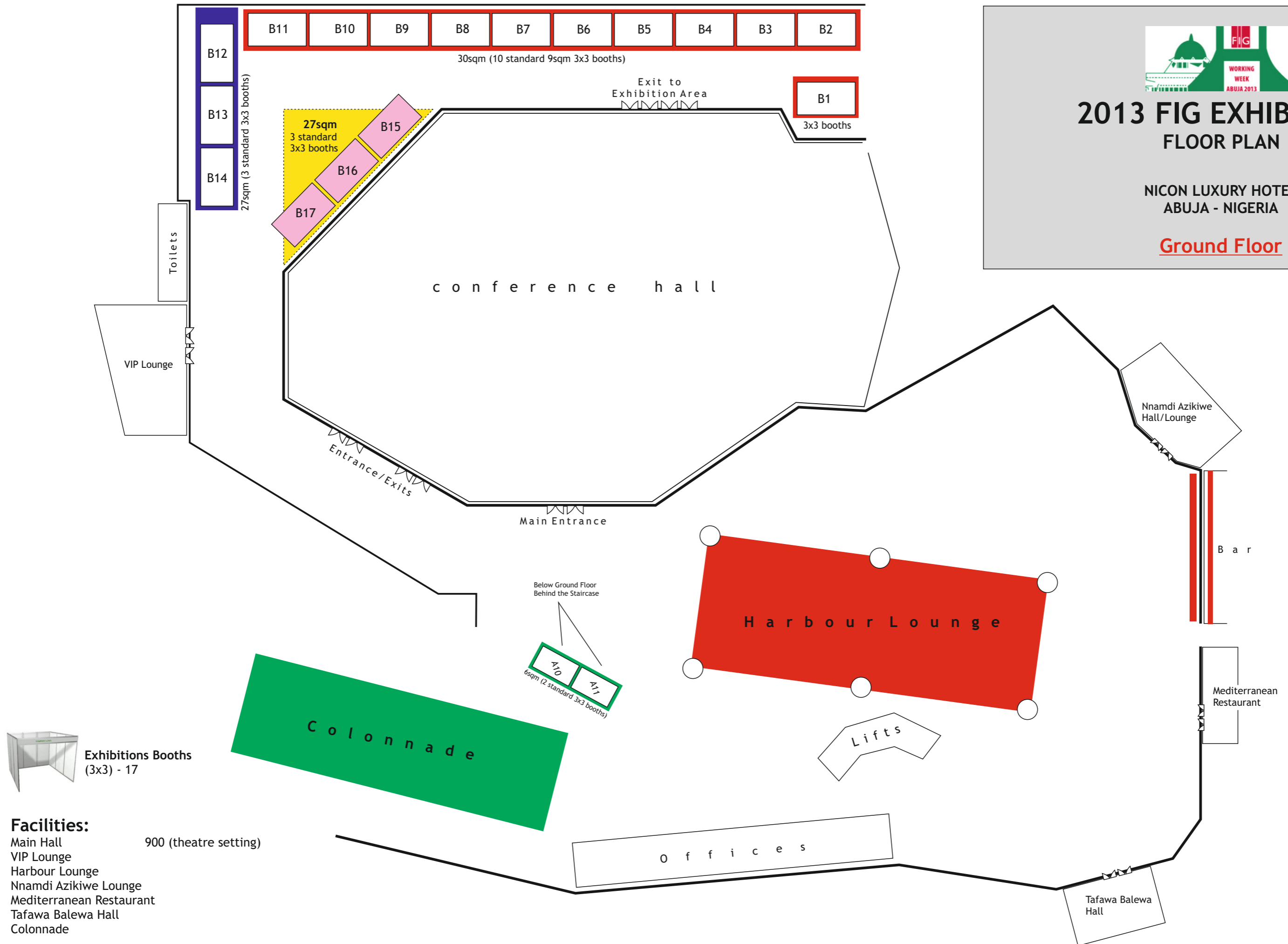

- Facilities:**
- Main Hall 900 (theatre setting)
 - VIP Lounge
 - Harbour Lounge
 - Nnamdi Azikiwe Lounge
 - Mediterranean Restaurant
 - Tafawa Balewa Hall
 - Colonnade



2013 FIG EXHIBITION FLOOR PLAN

INTERNATIONAL CONFERENCE CENTRE ABUJA - NIGERIA

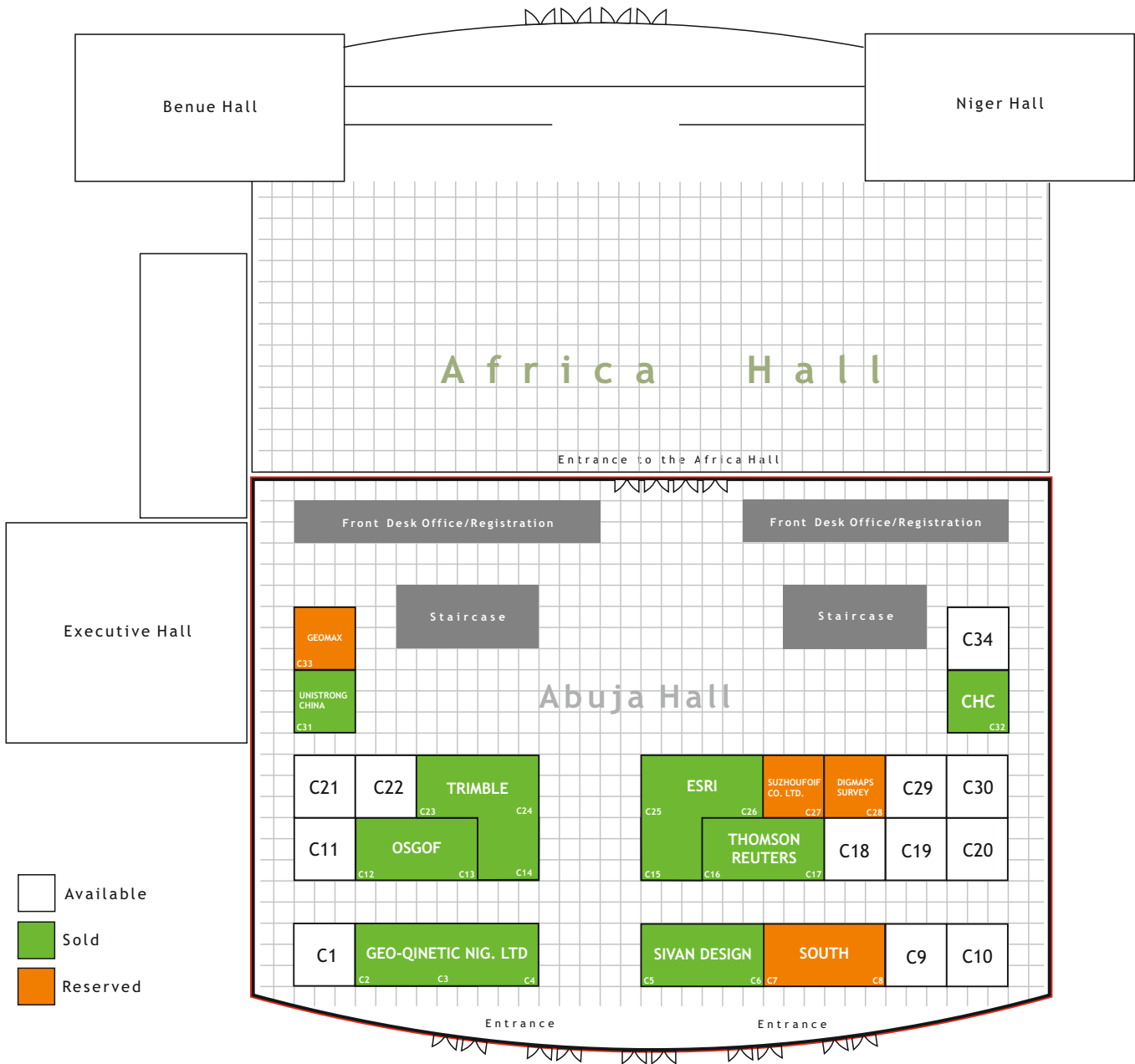

EXHIBITORS

TRIMBLE
ESRI
GEO-QINETIC NIG. LTD
THOMSON REUTERS
SIVAN DESIGN
OSGOF
UNISTRONG - CHINA
CHC

Exhibition

Location: International Conference Centre, Abuja
Hall: Abuja Hall

Booth Details:

Dimension: 3x3 (9sqm)
Number: 34
Type: Shell Scheme Stands

*Floorplan is subject to change

For further stand details contact:

Tel: +234 (0)803 718 3266
+234 (0)805 746 4880