

FIG Marrakech WW2011

**Geospatial architecture for the
Cree/Naskapi Land Registry System
as an economic development mechanism for
Canadian aboriginal people**

Presenter: Gabriel S. Arancibia, Canada

19 May, 2011

TSO1J – Land Registration

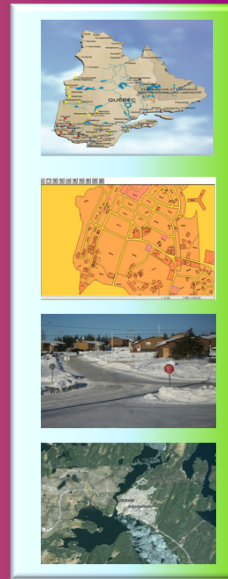

AECOM

Contents

- **Cree-Naskapi territory**
- **Aboriginal land rights regime**
- **Cree/Naskapi Land Property System**
- **The geospatial infrastructure**
- **The land registry on –line**
- **The benefits of the system for economic development and land planning.**



TSO1J – Land Registration

Geospatial architecture for the Cree/Naskapi Land Registry System ...

AECOM

Cree/Naskapi territory

Some statistics:

- **Eleven (11) aboriginal nations within Quebec.**
- **Ten (10) Cree/Naskapi communities.**
- **More than 20,000 people**
- **Extension of land to be registered : 3,342 km²**
- **Land with some type of rights: 76,668 km²**
- **More than 4,000 rights/interests subject to be registered.**
- **The reality before implanting the system (2011): less than 7% registered rights.**

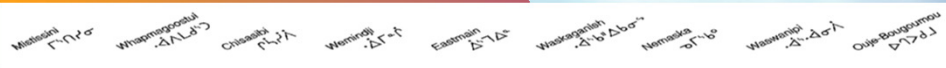

TSO1J – Land Registration

Geospatial architecture for the Cree/Naskapi Land Registry System ...

AECOM

Aboriginal Land Rights Regime

- **1763 – Royal proclamation - Recognition of territorial rights.**
- **1912 – Quebec Boundary Extension Act – Recognition of aboriginal rights.**
- **1973 – Hydroelectric work on the Nord of Quebec - Injunction**
- **1975 - James Bay and Northern Quebec Agreement (JBNQA) for the Cree**
- **1978 – Northeast Quebec Agreement (NEQA) for the Naskapis.**
- **1984 – Cree-Naskapi (of Quebec) Act**
- **1986 – Cree-Naskapi Land Registry Regulations**



TSO1J – Land Registration

Geospatial architecture for the Cree/Naskapi Land Registry System ...

AECOM

Aboriginal Land Rights Regime

Important considerations:

- The government of Canada was required to establish an administrative system (1984) to allow the aboriginal bands to manage the lands.
- Jurisdiction on the Cree/Naskapi Lands:
 - 1A and 1A-N Lands
 - 1B and 1B-N Lands
 - Category II Lands
 - Category III Lands

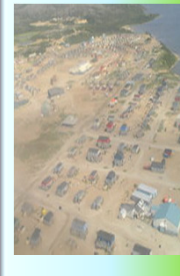

TSO1J – Land Registration

Geospatial architecture for the Cree/Naskapi Land Registry System ...

AECOM

Cree/Naskapi Land Property System

Land Property Right System

The Land Management

The Land Registry

The Land Surveying

TSO1J – Land Registration

Geospatial architecture for the Cree/Naskapi Land Registry System ...

AECOM

Cree/Naskapi Land Property System



The Land Management Sub-system:

This sub-system ensures that the rights granted are consistent with the government policy.

TSO1J – Land Registration

Geospatial architecture for the Cree/Naskapi Land Registry System ...

AECOM

Cree/Naskapi Land Property System



The Land Registry Sub-system (INAC):

It regulates the acquisition, exchange and transaction of land by maintaining a public land registry.

TSO1J – Land Registration

Geospatial architecture for the Cree/Naskapi Land Registry System ...

AECOM

Cree/Naskapi Land Property System



The Land Surveying Sub-system (NRCan):

This sub-system consists of identifying the extend of land rights or interest, and the geographical location.

TSO1J – Land Registration

Geospatial architecture for the Cree/Naskapi Land Registry System ...



Cree/Naskapi Land Property System

The Land Surveying Sub-System of NRCan : Integrated Cadastral System (ICS)

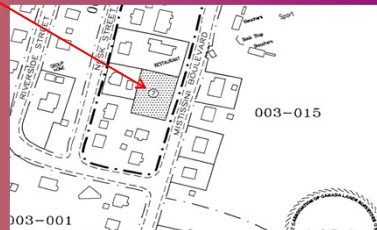
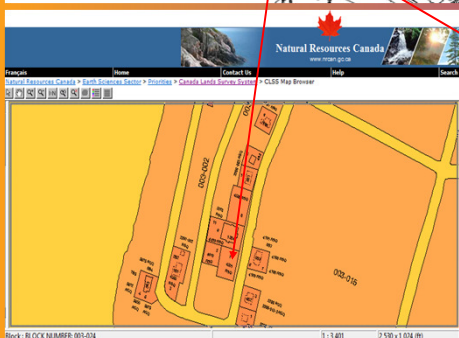

Extract of parcel plan 4501 RSQ QC
Crina number 08-003-7

TSO1J – Land Registration

Geospatial architecture for the Cree/Naskapi Land Registry System ...



The Geospatial Infrastructure

for the Land Registry Sub-system

Important components to describe the geospatial infrastructure:

1. The system environment
2. The data model



TSO1J – Land Registration

Geospatial architecture for the Cree/Naskapi Land Registry System ...

AECOM

The Geospatial Infrastructure for the Land Registry Sub-system - The system environment:

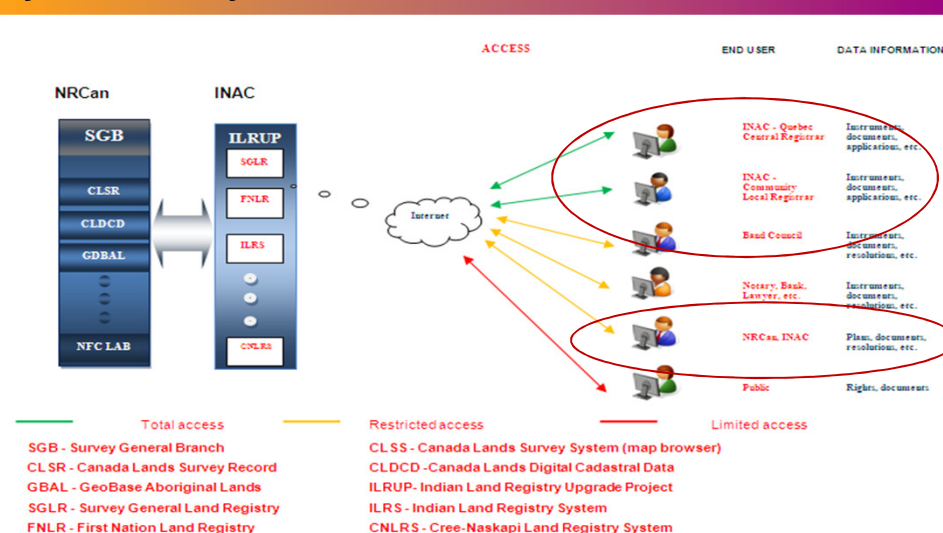

TSO1J – Land Registration

Geospatial architecture for the Cree/Naskapi Land Registry System ...

AECOM

The Geospatial Infrastructure for the Land Registry Sub-system - The data model:

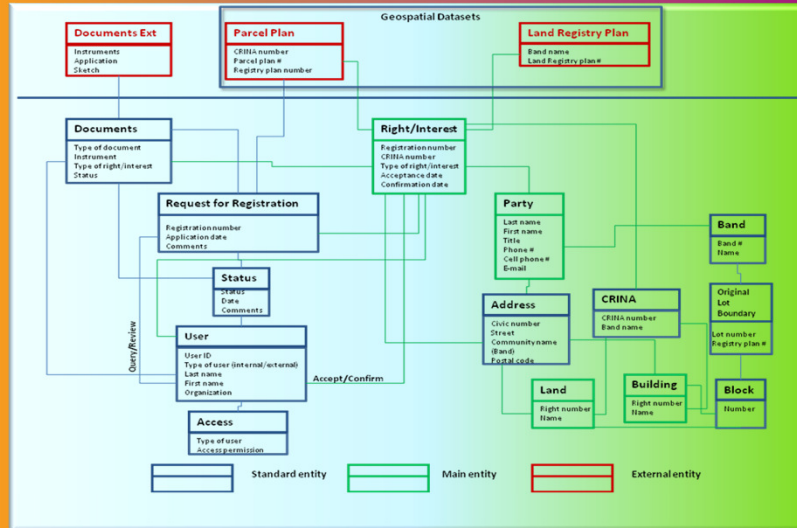

TSO1J – Land Registration

Geospatial architecture for the Cree/Naskapi Land Registry System ...

AECOM

The Land Registry Sub-system on-line

The main screen:

The screenshot shows the main screen of the online Land Registry Sub-system. It includes the following elements:

- Header: Canadian flag, 'Indian and Northern Affairs Canada / Affaires indiennes et du Nord Canada', and 'Canada' logo.
- Page Title: 'INT - Cree-Naskapi Land Registry' with the URL 'www.jmainsite-siteprimaire.gc.ca'.
- Navigation: 'Français', 'FAQ', 'Contact Us', 'ainc-inac.gc.ca'.
- Menu: 'HOME', 'INSTRUMENTS', 'LAND/BUILDING INTERESTS', 'REPORTS', 'HELP', 'Joe Smith', 'SYSTEM MAINTENANCE'.
- MY SAVED SEARCHES: A table with columns 'Name' and 'Instruments - Initiated Status'. One entry: '06127 - MISTASSINI - Building Interests'.
- SYSTEM MESSAGES: A list of messages including 'Example: System update 5:00 a.m. EST', 'TIP: % sign is the wildcard used for searches', 'User Guide v1.0 now available', and 'Build 117 has been deployed'.
- MY INBOX: A table with columns 'Registration Number', 'Type', 'System Create Date', 'Status', and 'Description/CRINA Number'.

Registration Number	Type	System Create Date	Status	Description/CRINA Number
1000111	Lease of Land/Building	2010-09-29	Pending	04-001-001-681 04-001-001-7
1000108	Mortgage	2010-09-27	Withdrawn/Deleted	test 118
4001918	Licence	2010-09-24	Received	LOT 21 LOT 51 LOT 56
6037915	Licence	2010-09-23	Initiated	test 117
- 61 - THE CREES OF THE WASKAGANISH FIRST NATION INBOX: A table with columns 'Registration Number', 'Instrument Type', 'System Create Date', 'Status', and 'Description/CRINA Number'.

Registration Number	Instrument Type	System Create Date	Status	Description/CRINA Number
1000111	Lease of Land/Building	2010-09-29	Pending	04-001-001-681 04-001-001-7
1000108	Mortgage	2010-09-27	Withdrawn/Deleted	test 118
4001918	Licence	2010-09-24	Received	LOT 21 LOT 51 LOT 56

TSO1J – Land Registration

Geospatial architecture for the Cree/Naskapi Land Registry System ...

AECOM

The Land Registry Sub-system on-line

The search mechanism:

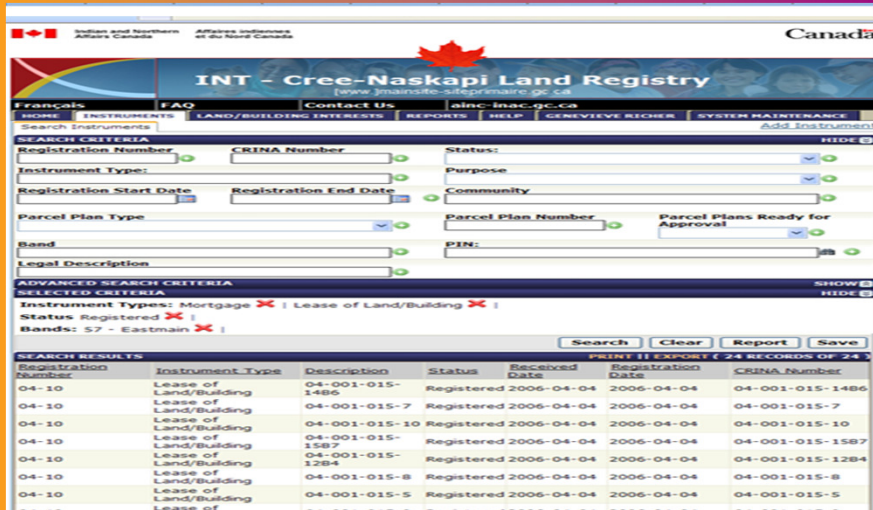

TSO1J – Land Registration

Geospatial architecture for the Cree/Naskapi Land Registry System ...



The Land Registry Sub-system on-line

The Electronic Registry Index Plan (eRIP):

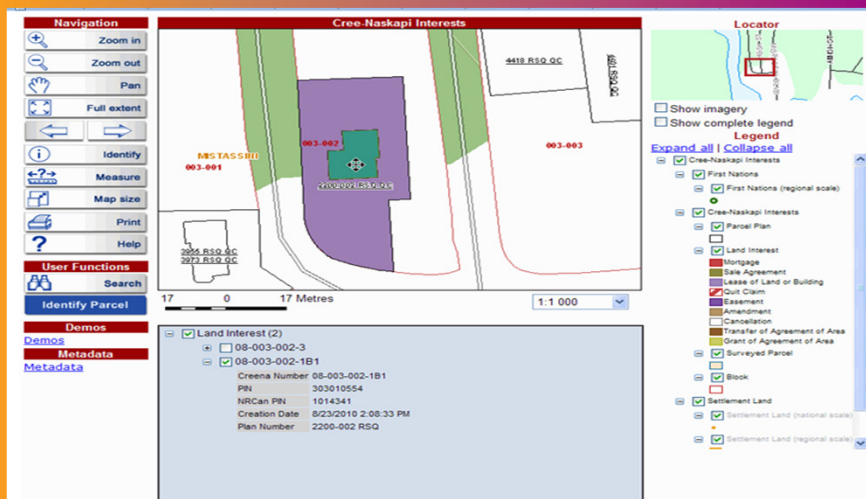

TSO1J – Land Registration

Geospatial architecture for the Cree/Naskapi Land Registry System ...



The Benefits of the CNLRS for economic development and land planning

- *Fast track and flexible solution*
- *The proposed technology meets institutional departmental IT standards*
- *Efficient on-line registration process*
- *Faster synchronisation mechanisms between land registry and geographic information*
- *Reliable and user-friendly system for other kinds of land administration and planning applications*



TSO1J – Land Registration

Geospatial architecture for the Cree/Naskapi Land Registry System ...

AECOM

Thanks! Merci beaucoup! Choukrane!



TSO1J – Land Registration

Geospatial architecture for the Cree/Naskapi Land Registry System ...

AECOM